

Pot - Strainer

with flat screen
of welded construction

NORIS

Bauform 155

Application:

Preferably installed in front of measuring instruments, control valves, pumps and sensitive systems.

Operating Conditions:

Working pressure: 6 - 40 bar
Open area of screen: more than 1,5 x area of size

Installation:

Optional; Take care of flow direction

Option:

Flanges acc. DIN or ANSI
Butt Welding Ends
Sight glass in cover

Materials:

Body	WN 1.4571	Steel
Screws	A4 - 70	5.6
Nuts	A4 - 70	5.2
Screen	WN 1.4571	
Gaskets	Klingsil C-4400	

Example for an order:

Pot strainer Bauform 155
1.4571; mesh size 2.0 mm
Flanges DN 150 PN 16

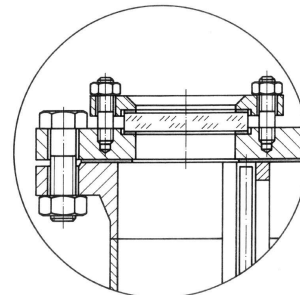
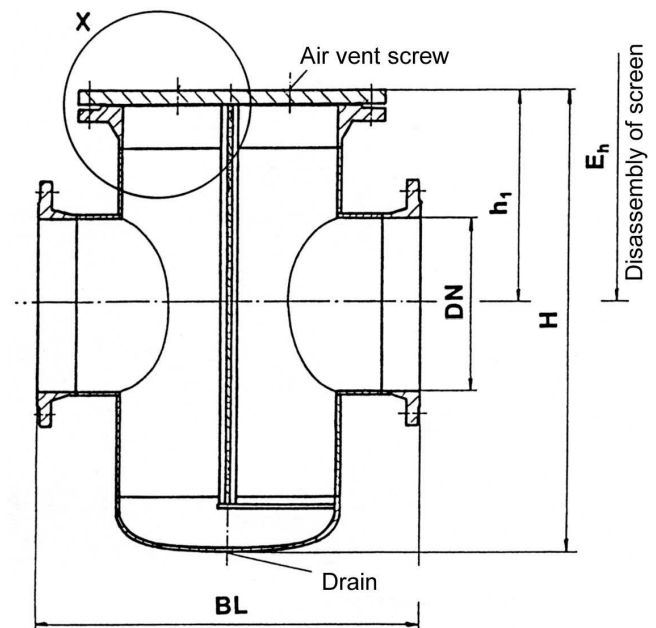

Special design with sight glass in cover



Dimension:

DN	BL	H	h ₁	E _h
50	230	235	150	350
65	290	280	170	400
80	310	330	195	440
100	350	365	220	490
125	400	380	215	500
150	480	465	275	620
200	600	565	280	720
250	600	720	340	900
300	700	870	415	1120
350	800	1000	440	1200
400	900	1115	455	1265

Modification reserved

NORIS ARMATUREN Burkenstein GmbH & Co. KG

Puscherstrasse 3
D-90411 Nürnberg

Telefon: +49 (0) 911 / 52 150 63
Telefax: +49 (0) 911 / 52 24 40

Internet: Noris-Armaturen.de
E-Mail: Noris@Noris-Armaturen.de