

# Hydraulic Clamp Nut

## Piston system

# NORIS

## Series N10.02

### Features of series

**Axial operating  
with Allen key**

**Medium remains into the system**



The actuator screws has to be turned into the body by using the enclosed Allen key.  
The internal medium will flow into the circular groove and raise the ring piston.  
With less manual force you create a big hydraulic clamping force.  
For to relieve the clamp nut put the actuator screws to the start position  
and move the nut to the opposite direction.  
The medium remains into the system.

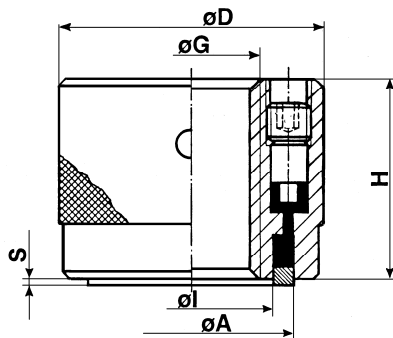

**Clamping range 2 mm**

Thread $\sigma G_{max.}$	Ring piston		Outer Diameter $\sigma D$	Height $H$	Clamping force (achieved by hand) in kN	Part No Clamping range S 2 mm
	$\sigma A$	$\sigma I$				
16	28	22	44	40	25	110.02.016
20	34	26	48	47	40	110.02.020
24	40	32	56	47	40	110.02.024
30	46	38	63	48	50	110.02.030
36	52	44	70	50	55	010.02.036
42	62	50	80	60	95	010.02.042
52	72	60	90	60	110	010.02.052
68	92	82	110	60	120	010.02.068
80	100	88	120	70	160	010.02.080
100	125	110	145	80	190	010.02.100

Against corrosion our hydraulic clamp nuts are protected with a brown finish.  
The standard sealing systems are suitable for temperatures up to 80°.  
The ring piston is locked against drop out.

Special design of hydraulic clamp nuts on request

# NORIS

## ARMATUREN BURKENSTEIN GMBH & CO. KG

– ABTEILUNG SPANNELEMENTE –

D-90411 Nürnberg  
Puscherstraße 3

Telefon: + 49 (0) 911/ 52 15 06 3  
Telefax: + 49 (0) 911/ 52 24 40

E-Mail: [noris@noris-armaturen.de](mailto:noris@noris-armaturen.de)  
Internet: [www.noris-armaturen.de](http://www.noris-armaturen.de)